

CENTENNIAL CROSSING METRO. DISTRICT #1

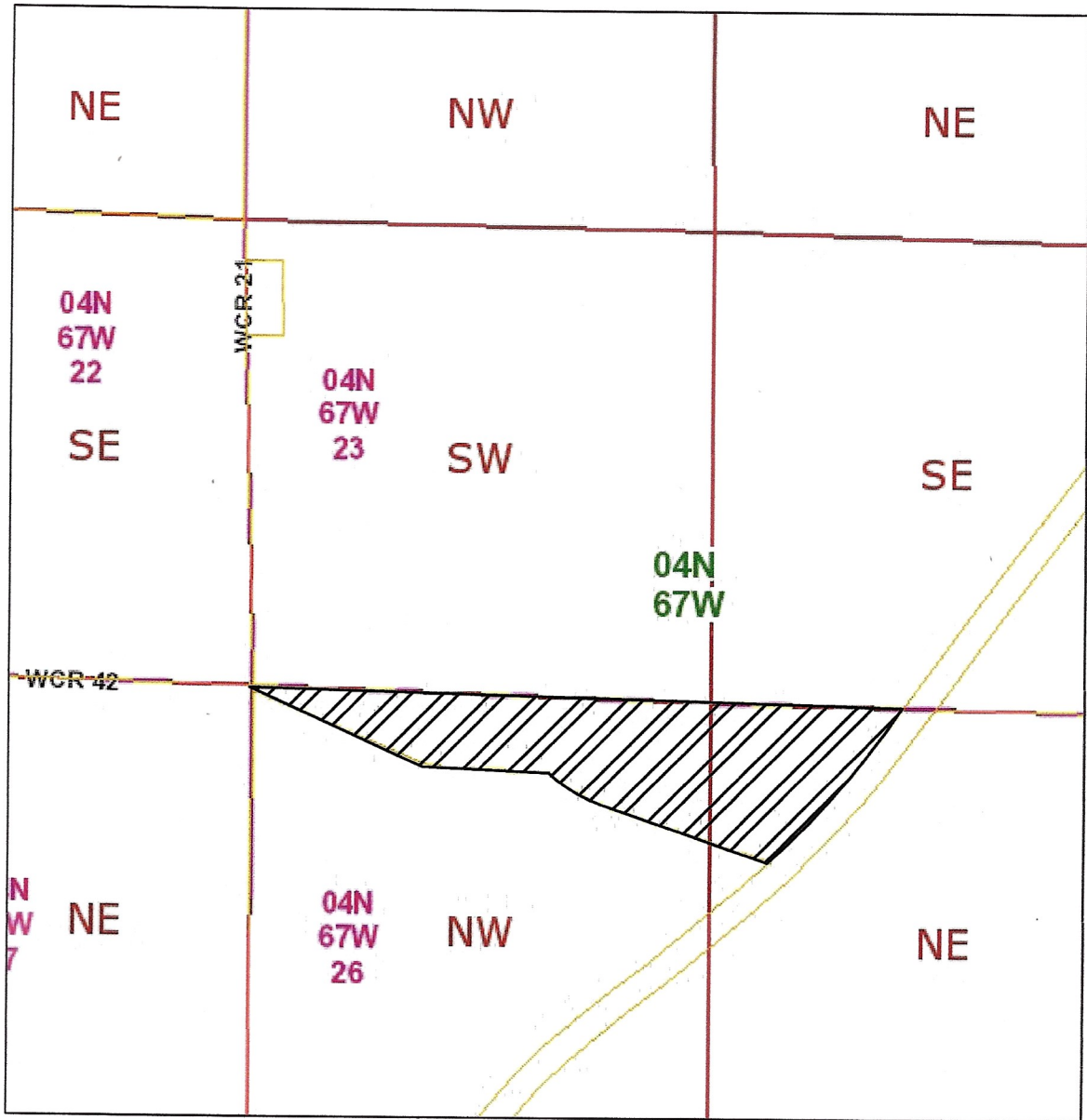

SURVEYOR'S CERTIFICATE

I, Erik Jay Snyder do hereby certify that this Exhibit Map was prepared by me or under my direct supervision and that it is correct to the best of my knowledge and belief. It is not to be construed nor does it represent a monumented land survey by this office.

By: _____
 Erik Jay Snyder
 On Behalf of Snyder Land Surveying Inc.



Snyder Land Surveying Inc.
 Professional Land Surveyor
 Erik Jay Snyder; PLS 38555
 O: 970-686-5157
 C: 724-992-8754
 E: SnyderLandSurveying@outlook.com
 W: SnyderLandSurveying.com

CLIENT: LOT HOLDINGS INVESTMENTS, LLC	
TITLE: EXHIBIT MAP – METRO DISTRICT #1	
DATE: 13 OCT. 2021	SCALE: 1"=1000'
JOB NO: LOTH-21-10-004	